



KTH ROYAL INSTITUTE
OF TECHNOLOGY

KTH Royal Institute of Technology

Master's studies 2022



A brighter tomorrow begins here

Welcome to KTH, an illustrious university with a rich history of pioneering ideas and innovation that dates back nearly 200 years. Our talented researchers and academics continue to work in our state-of-the-art facilities to discover new advances that will benefit industry and, more importantly, society as a whole.

Our extensive, international student body and partnerships with universities around the world make KTH an inspiring environment with a global perspective, where master's students can discover the full potential of their chosen field of study. I am proud to be part of such an outstanding institution.



Sigbritt Karlsson

Prof. Sigbritt Karlsson
President of KTH

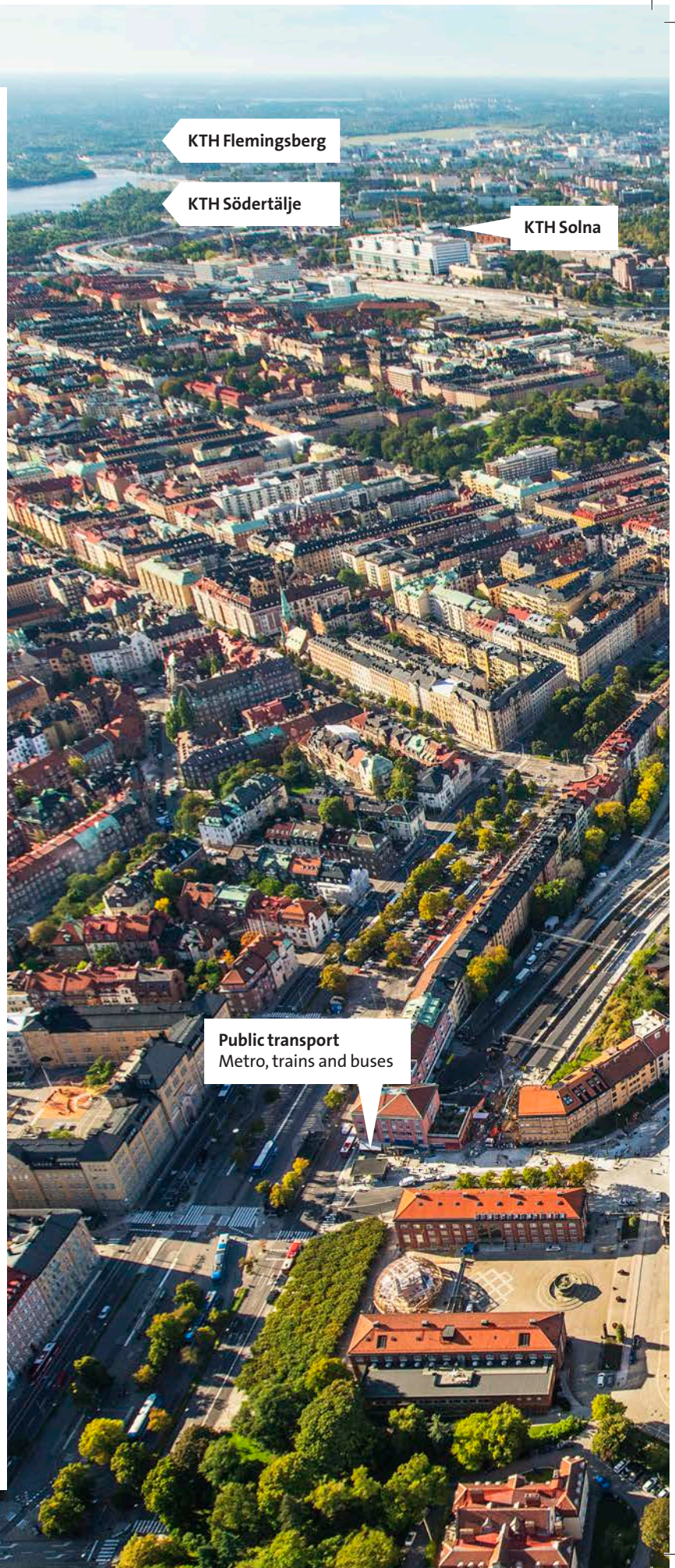



KTH Kista

AlbaNova
Stockholm Center for
Physics, Astronomy
and Biotechnology

**The Royal National
City Park**

KTH-hallen
Sports centre

President's Office

Nymble
Student union building

Beskow
Sweden's fastest
supercomputer

KTH Library

KTH Entré

KTH Campus courtyard

This is KTH

KTH Royal Institute of Technology is the largest and most respected technical university in Sweden—ranked top 100 in the 2022 QS World University Rankings. By choosing KTH, you gain access to a vibrant student life and a prestigious academic environment.

KTH was established in 1827, and since its inception, KTH has been at the centre of the technological advances in Sweden. KTH conducts world-class research in an array of technology and engineering fields. Its strong research reputation has reinforced the university's position as one of the most prominent technical universities in Europe and a force to be reckoned with globally.

Sweden and KTH have a tradition of attracting talents from all corners of the world. At KTH, you will have the opportunity to meet a diversity of people with different experiences, who will widen your horizons and challenge you to excel. The openness to new ideas is a

central part of life at KTH. Students call professors by their first names, researchers welcome new thoughts from students and the curriculum is focused on personal development as well as knowledge.

KTH inspires students to look for innovation in challenges and real-world problems. All graduates should have up-to-date knowledge and tools to move society in a more sustainable direction. Therefore, sustainability is integrated into the curriculum of all programmes. For almost 200 years KTH has educated students who have gone on to influence our present and make technological advances that improve our society.

KTH in numbers

- 13,500 full-time students
- 1,700 doctoral students
- 317 professors
- 287 associate professors
- 60 master's programmes

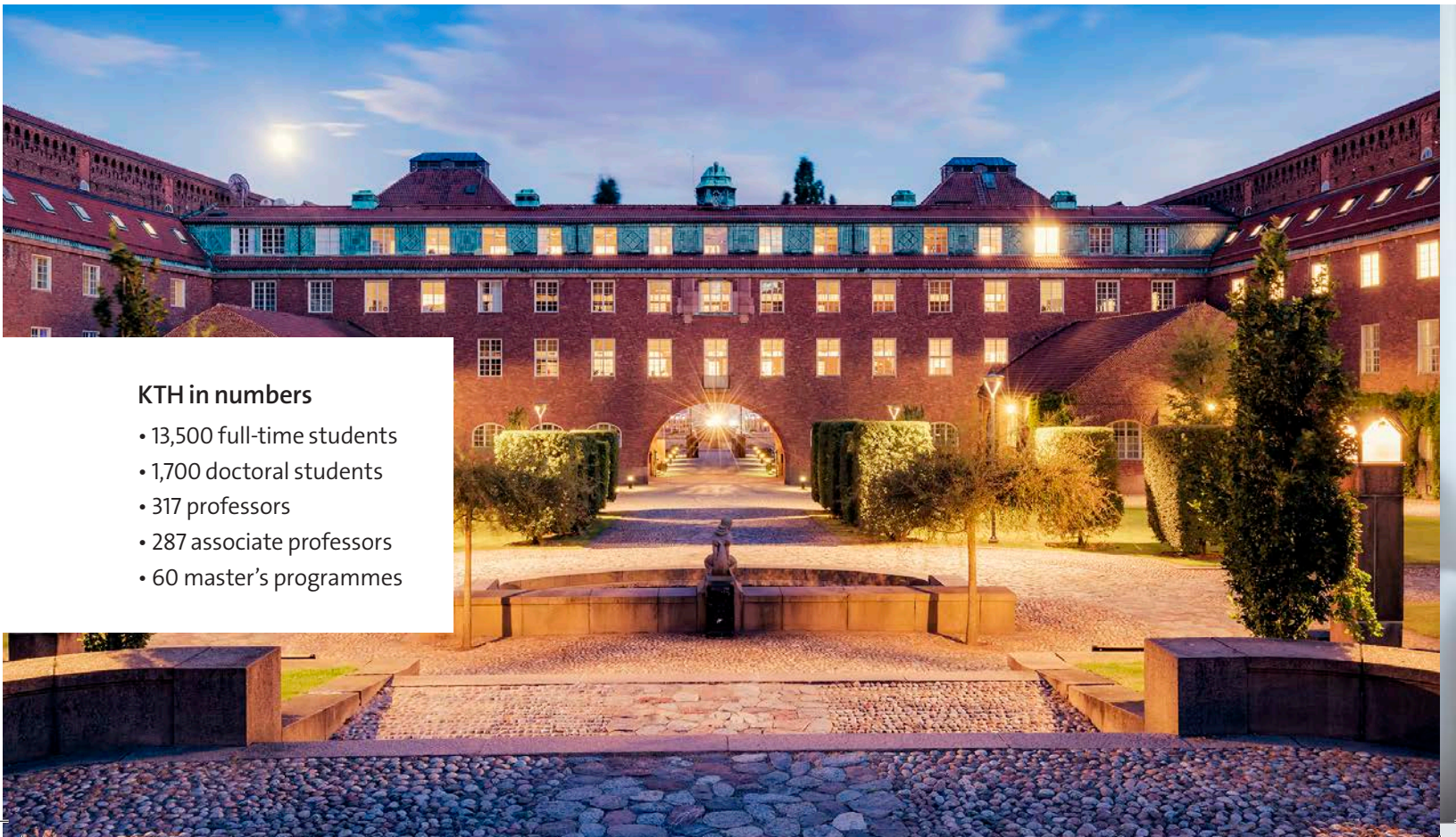

Five campuses in Stockholm

KTH has five campuses in the Stockholm region. Strategic placements of the campuses enables in-depth collaboration with industry and the surrounding community, all with a shared focus on digitalisation, sustainability, internationalisation and equality.

KTH's main campus is located in central Stockholm and could be described as a small town in the middle of a big city. It has been an important centre for research and education since the early 20th century.

KTH Kista campus is situated in the heart of Kista Science City, home to over 1,000 ICT companies such as Ericsson, IBM and Microsoft. Close collaboration with these companies creates unique opportunities for students to interact with industry.

KTH Flemingsberg campus is situated in one of Northern Europe's key areas for medical technology. In Flemingsberg, KTH is joined by Karolinska Institutet

and Södertörn University College, creating a student community with over 10,000 students.

KTH Södertälje campus is constantly evolving through close co-operation with companies such as Scania and AstraZeneca. This is the southernmost and smallest KTH campus, making it a close-knit student community.

KTH Solna is located in an important national hub for research within various life science disciplines. The main focus of the campus is the Science for Life Laboratory, a joint effort between the highest ranked universities in Scandinavia (KTH, Karolinska Institutet, Stockholm University and Uppsala University).

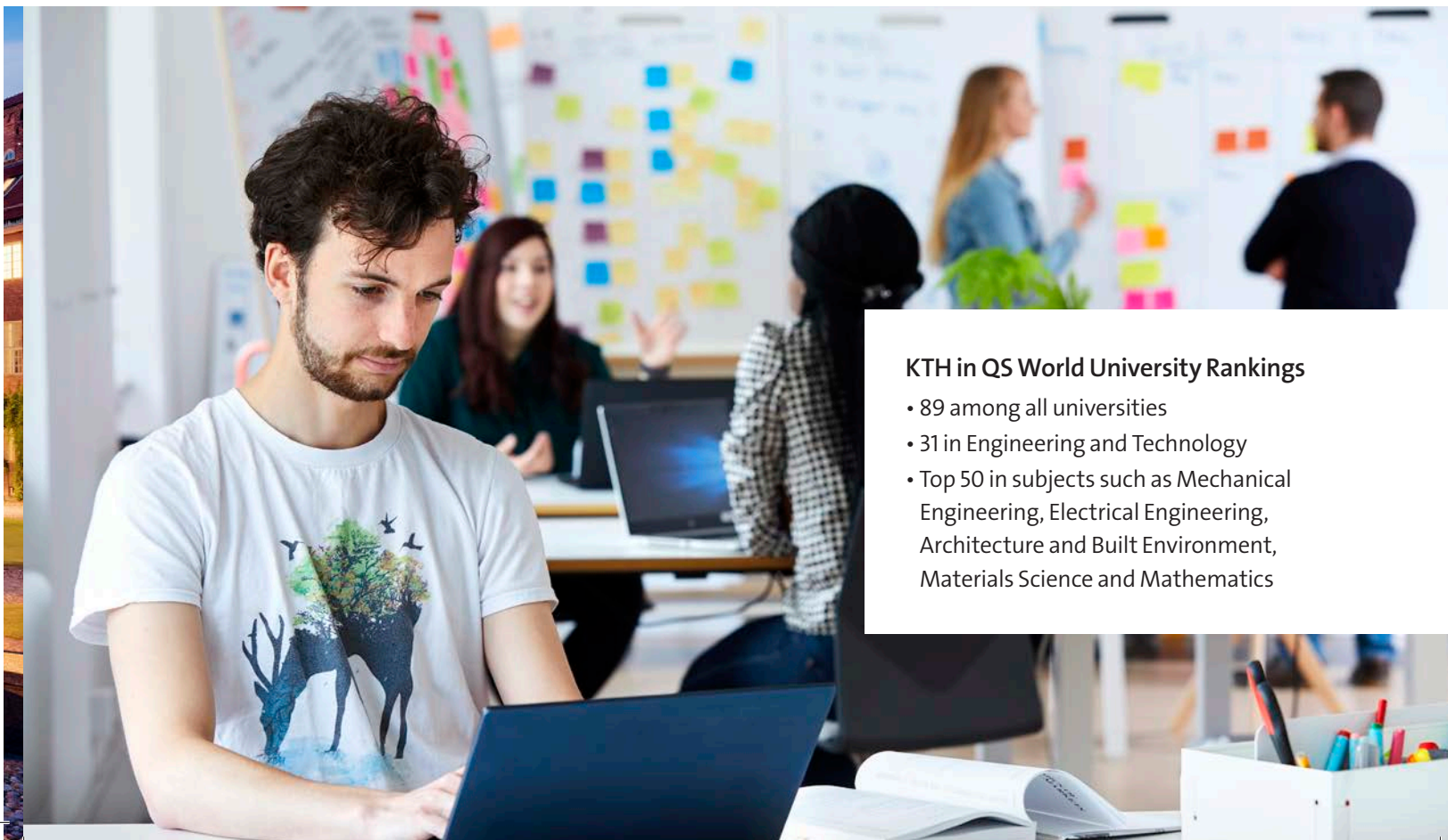

KTH in QS World University Rankings

- 89 among all universities
- 31 in Engineering and Technology
- Top 50 in subjects such as Mechanical Engineering, Electrical Engineering, Architecture and Built Environment, Materials Science and Mathematics

How to apply

The application period for most master's programmes is between 18 October 2021 and 17 January 2022. You apply University Admissions, the Swedish national application system.

1 Choose programmes

Find one or more programmes and verify that you meet the general and programme specific admission requirements. All programmes together with information on requirements, future career opportunities, sustainable development and students' experiences are presented on the KTH website, www.kth.se/master.

2 Submit your online application by 17 January

You can apply to up to four programmes and these should be ranked in your order of priority. Create an account, select your programmes and submit your application on the University Admissions website, www.universityadmissions.se.

3 Submit your required documents by 1 February

Your application will be considered incomplete if you do not submit all the required documents.

4 Pay the application fee or document your citizenship by 1 February

If you are not a citizen of an EU/EEA country or Switzerland, an application fee of SEK 900 is required. Citizens of an EU/EEA country or Switzerland are not required to pay the application fee, but must prove their citizenship status.

5 Check the selection results on 7 April

The notification of selection results will be published on the University Admissions website 7 April. You do not need to reply to your offer. If you are admitted, KTH will provide further information about how to prepare for your studies.

Some joint programmes have other application processes and deadlines. Detailed information for each programme is found at www.kth.se/apply.



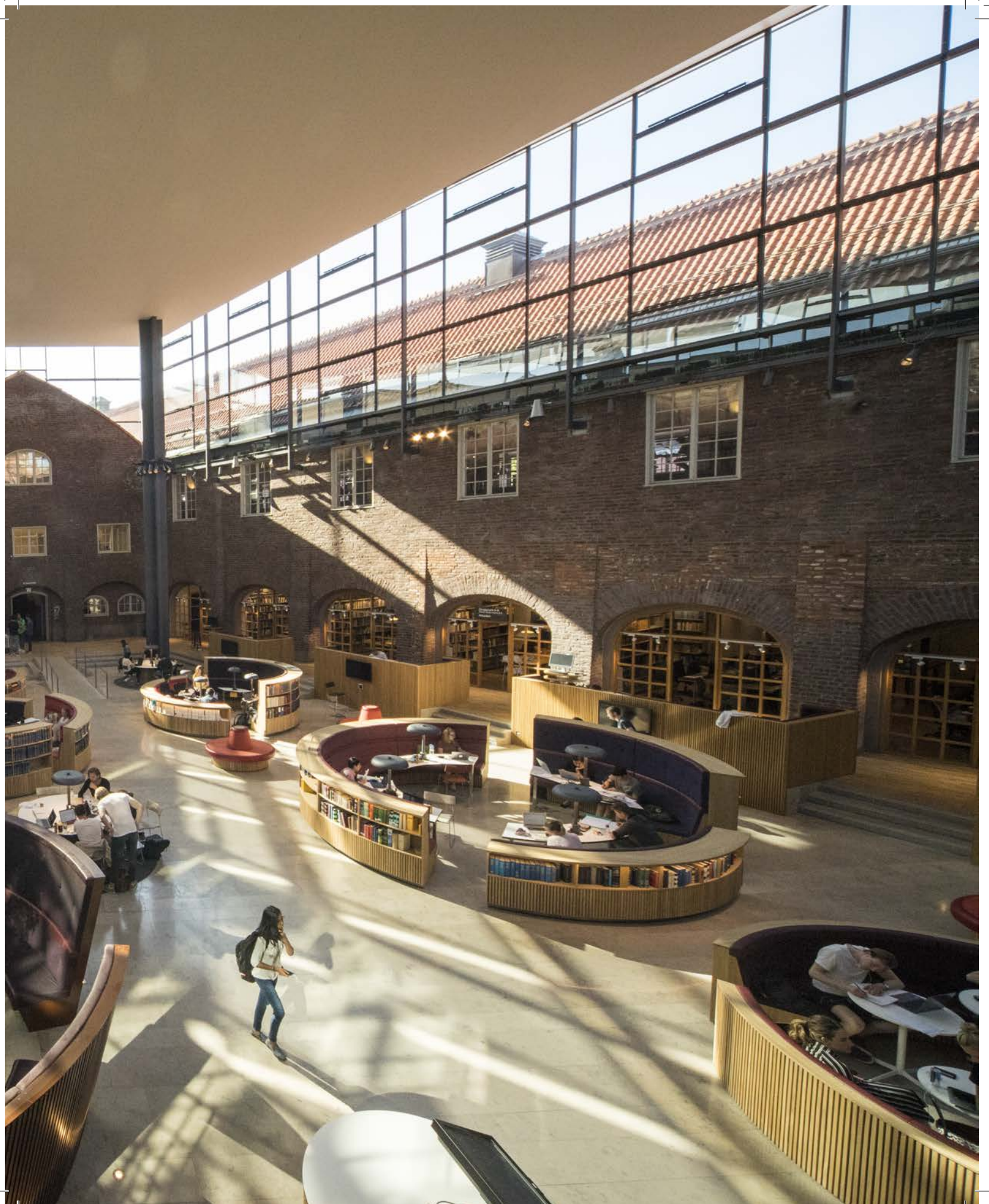

Master's programmes

KTH is organised into five schools that together offer 60 master's programmes. The programmes are taught in English and generally last two years. 16 of the programmes are joint programmes given in collaboration with other prominent universities.

Architecture and the Built Environment

- Architectural Lighting Design (One year)
- Architecture
- Civil and Architectural Engineering
- Environmental Engineering and Sustainable Infrastructure
- Real Estate and Construction Management
- Sustainable Technology
- Sustainable Urban Planning and Design
- Transport and Geoinformation Technology
- Transport, Mobility and Innovation (Joint EIT)

Electrical Engineering and Computer Science

- Communication Systems
- Computer Science
- Cyber Security
- Electric Power Engineering
- Electromagnetics, Fusion and Space Engineering
- Embedded Systems
- Energy for Smart Cities (Joint EIT)
- ICT Innovation
- ICT Innovation (Joint EIT)
- Information and Network Engineering
- Interactive Media Technology
- Machine Learning
- Nanotechnology
- Nuclear Energy (Joint EIT)
- Renewable Energy (Joint EIT)
- Security and Cloud Computing (Joint Erasmus+)
- Smart Electrical Networks and Systems (Joint EIT)
- Software Engineering of Distributed Systems
- Systems, Control and Robotics

Engineering Sciences

- Aerospace Engineering
- Applied and Computational Mathematics
- Computer Simulations for Science and Engineering (Joint)
- Engineering Mechanics
- Engineering Physics
- Mathematics (Joint)
- Naval Architecture
- Nuclear Energy Engineering
- Railway Engineering
- Vehicle Engineering

Engineering Sciences in Chemistry, Biotechnology and Health

- Chemical Engineering for Energy and Environment
- Industrial and Environmental Biotechnology
- Innovative Technology for Healthy Living (Joint EIT)
- Macromolecular Materials
- Medical Biotechnology
- Medical Engineering
- Molecular Science and Engineering
- Molecular Techniques in Life Science (Joint)
- Polymer Technology (Joint Nordic Five Tech)
- Sports Technology
- Technology, Work and Health

Requirements and fees

Industrial Engineering and Management

- Decentralized Smart Energy Systems (Joint Erasmus+)
- Entrepreneurship and Innovation Management (One year)
- Engineering Design
- Engineering Materials Science
- Environomical Pathways for Sustainable Energy Systems (Joint EIT)
- Industrial Management
- Innovative Sustainable Energy Engineering (Joint Nordic Five Tech)
- Integrated Product Design
- Production Engineering and Management
- Sustainable Energy Engineering
- Sustainable Production Development

EIT, Erasmus+ and Nordic Five Tech

KTH offers joint programmes as part of the prestigious EU collaboration European Institute of Innovation and Technology (EIT). KTH also offers joint programmes with European institutions through Erasmus+ and the leading technical universities in the Nordics as part of Nordic Five Tech. Students generally spend one year at KTH and one at a partner university, receiving two degrees.

Admission requirements

Admission to a master's programme requires:

- A completed bachelor's degree or comparable qualifications equivalent to a Swedish bachelor's degree (180 ECTS credits) from an internationally recognised university. A bachelor's degree in Science or Engineering is required for most programmes.
- English proficiency can be demonstrated through an internationally recognised English test for example IELTS Academic 6,5 (no section lower than 5.5) or TOEFL iBT 90 (20 in written test).
- Programme specific requirements are listed in the programme descriptions.

The selection process is highly competitive, since students who meet the entry requirements compete for a limited number of places based on merit. All applications are assessed according to the selection criteria set for the programme. You can find the full admission requirements and the selection criteria for each programme at www.kth.se/master.

Fees and scholarships

Citizens of an EU/EEA country or Switzerland are not required to pay application and tuition fees, with the exception of some joint programmes. If you are not a citizen of an EU/EEA country or Switzerland, you are generally required to pay application and tuition fees. The tuition fee for most two year programmes is SEK 310,000 (€29,000).

For students required to pay tuition fees, there are a limited number of KTH and external scholarships available. Every year, KTH awards around 35 scholarships based on academic excellence: KTH Scholarship, KTH One-Year Scholarship and KTH Joint Programme Scholarship.

You can find complete information on fees and scholarships for each programme at www.kth.se/fees.



KTH graduates all over the world

Through KTH's world-wide alumni community you are able to maintain and widen your social and professional network. Every year KTH invites graduates to take part in a wide range of events on campus or hosted by our international alumni chapters. KTH has official alumni chapters in, for example, Australia, Brazil, China, Germany, India, Indonesia, Japan, Norway, Singapore, Spain, Switzerland, Tanzania, Thailand, United Kingdom and USA.

Career after KTH

A KTH degree is a sign of academic excellence, ambition and an innovative mind-set. KTH graduates are highly attractive on the job market and have succeeded in a wide range of fields.

A reputation that precedes you

A degree from KTH is a springboard to a successful career. KTH graduates are quickly established in the job market. Over half of KTH graduates have acquired jobs before receiving their degree. In the QS Graduate Employability Rankings 2020, KTH ranked as the 75th best university in the world for employer reputation.

Each year, over 500 degree project proposals are posted on the KTH project portal by companies such as Ericsson, SAAB and Scania. Over 20 per cent of the students get their first employment through their degree projects. KTH Career service helps students achieve their future plans through career planning, career development seminars and job application support.

The innovative mind-set

As the home of the Nobel Prize, Sweden is known for its innovation and entrepreneurship, with inventions ranging from the steam turbine and dynamite to Bluetooth and Skype. At KTH Innovation, students are given support to commercialise their business ideas and 15 percent of KTH graduates start their own company.

Doctoral studies (PhD)

KTH's dynamic international research environment and world-class facilities make it an excellent choice for PhD studies. Typically, doctoral students are employed by KTH and receive a monthly salary. Vacant doctoral positions are published regularly on www.kth.se/phd.



Charlene Sequeira
Consultant Manager at the Cybercom Group in Stockholm

“Right now I am developing radio software solutions for Ericsson’s 5G radios. At KTH I had a lot of project-based courses, teaching me how people differ in their thinking process, how they plan and how they handle disagreement. These skills are now the backbone of any professional life. Moving to Sweden to study at KTH was the best decision I’ve ever made!”



Anirudh Deshpande
CAE Engineer at Scania in Södertälje, Sweden

“I work in R&D with engine development. My studies at KTH were very comprehensive and had good industry-academia partnerships. Being involved in industry projects during my studies really helped me understand the complexities and challenges involved in product development. But the thing I enjoyed the most about KTH was meeting new people that helped me look at things from a new perspective.”

Get to know us better

Do you want to know more about studies and life as a student at Sweden's largest and most prestigious technical university? There are a lot of ways to get to know us better.

Ask a KTH student

Through our website, you can contact 50 students from all over the world who are studying at KTH. You can ask them about anything from course literature to the availability of your national cuisine in Stockholm.

The International Student Blog

The international student bloggers will give you a glimpse of their daily life as students at KTH. You can find and follow them at www.kth.se/studentblog

Follow KTH

Keep up with the latest activities and news through our official social media.

 KTH Royal Institute of Technology

 KTHuniversity

 KTHuniversity

 KTH Royal Institute of Technology

 kthuniversity

Also, subscribe to the newsletters for prospective students and you will receive important real-time information to make your path to KTH as smooth as possible. Go to www.kth.se/follow to subscribe.





Maya from Lebanon

Master's programme in Civil and Architectural Engineering

"One of the things I value most about KTH is how integrated it is within Stockholm's job market. Our lectures are given by some of the brightest names in Sweden's engineering society, which is valuable for aspiring engineers looking for a practical view of the field, including the challenges they will face and the tools they will use when they eventually leave the classroom."



Erasmus from South Africa

Master's programme in Sustainable Urban Planning and Design

"I think KTH has a relaxed and enjoyable atmosphere. It is refreshing to gain a solid education whilst being able to learn about new cultural experiences, as well as have great access to the industry through activities on campus throughout the year and make friends in an international city. The campus is located between a vast natural landscape and the city, giving you the best of both worlds."



Yuxuan from China

Master's programme in Computer Science

"What attracted me to KTH was the well-designed tracks and courses that students can choose from. Students here not only acquire broad knowledge in their major, but also become specialists in one area. I have plans to pursue a PhD degree so it is really important for me to find my own interests. Here at KTH you can enjoy a peaceful study life and have time to plan for your future."



Akshat from India

Master's programme in Integrated Product Design

"The adventures and excitement of your student life in Stockholm begin the moment you arrive here. Starting with the international reception, you enter this amazing world of being a student at KTH. There are so many events, lectures, parties and fairs that take place throughout the year. And the blend of nature, history and modernity makes Stockholm a very beautiful place to live."

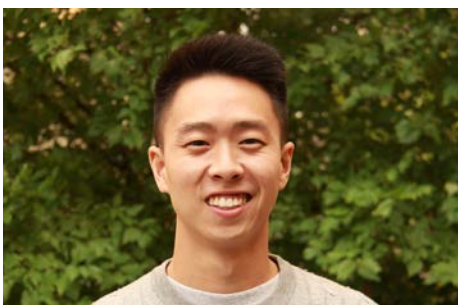

Siwat from Thailand

Master's programme in Aerospace Engineering

"Stockholm has an exceptionally high quality of life and is considered to be one of the most environmentally friendly cities in the world. There are plenty of parks and green areas in the heart of the city that are accessible to everybody. After I complete my master's degree, I plan to start work on my PhD. I want to contribute to the field and make the world a better place."





Life in Stockholm

Stockholm, the capital of Sweden and home of KTH, consistently ranks as one of the greenest, most high-tech and most enterprising cities in Europe.

Stockholm was founded in the 13th century and is situated on the east coast of Sweden, bordering the Baltic Sea. With 2.1 million inhabitants, it is the heart of Swedish trade and business life, and is known for its rich cultural history and closeness to nature. Stockholm is situated on 14 islands, giving you sea views at almost every street corner.

Even though Sweden is a small country, home to just 0.13 per cent of the global population, it is a world leader in innovation. Sweden's entrepreneurial spirit is fuelled by a historic tradition of inventors, a supportive start-up culture, and a close collaboration between research and industry.

The city's rich intellectual heritage and entrepreneurial environment make it the ideal place for international students to put their learning into practice.

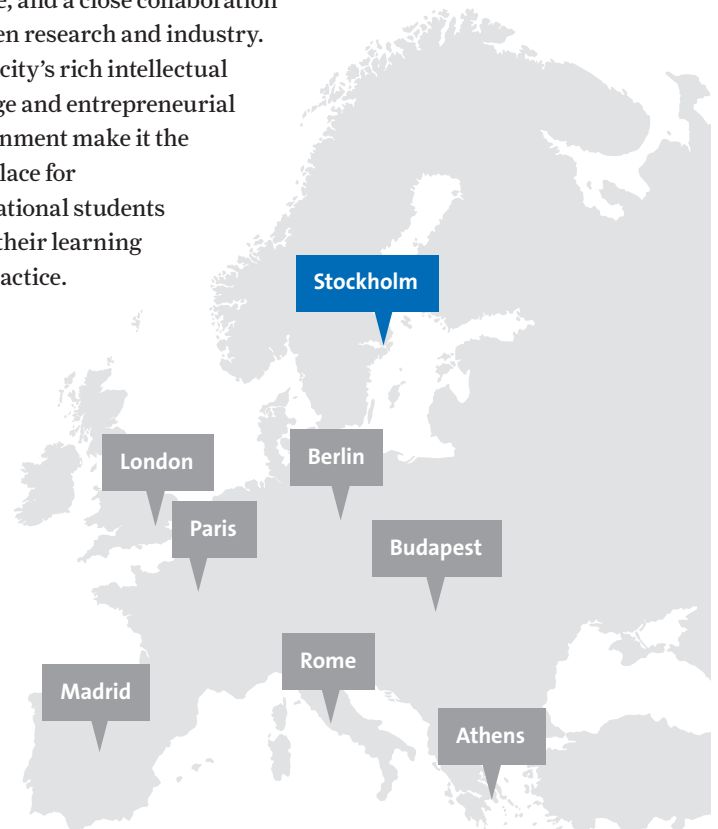

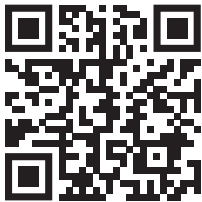

Print: Elanders Sverige AB, August 2021, ISO 9001:2015, ISO 14001:2015, climate neutral and Nordic Swan Ecolabel print house. Printed on PEPC/O5-233-98 and FSC® C007342 certified paper produced in Sweden.

Photo: Emilia Bergmark-Jiménez, Karlberg media, Folio, Fredrik Persson, Simon Paulin/imagebank.sweden.se, Kalle Börjeson, Jann Lipka, Anne-Sofie Eriksson/mediabank.visitstockholm.com

